



# The finest family holidays on the Fife coast



- ▶ Self-catering lodges with hot tubs, holiday homes & cottages
- ▶ Touring caravan, motorhome and tent holidays
- ▶ Award-winning coastal holiday parks across Fife, Scotland

**Tourers  
& Tents  
BOOK ONLINE  
SAVE 10%**

**Book online at [abbeyford.com](http://abbeyford.com)**





Holiday  
lodge  
4 nights  
from  
£307

Holiday  
home  
4 nights  
from  
£199

Touring  
pitches  
from £17.28  
per night\*

Includes awning  
and hook-up

#### We welcome:

-  Motorhomes
-  Campervans
-  Touring caravans
-  Trailer tents
-  Tents
-  Dogs

Please see individual  
park pages

#### Our Locations



See pages 10 - 25

Prices correct at time of going to print.  
\*See pricelist or abbeyford.com for details.  
†Available on selected holiday homes.

## The finest family holidays on the Fife coast

Book your holiday with Abbeyford Leisure and you book with confidence knowing that we've been creating smiles and memorable holidays for over 70 years.

St Andrews Holiday Park has been shortlisted as a finalist for Scotland's Best Family Holiday Park in the Scottish Outdoor Leisure Awards and Trip Advisor has awarded Elie Holiday Park with their acclaimed Travellers' Choice accolade.

Stay in a lodge with your own private hot tub and enjoy some of the best views of St Andrews, or enjoy the freedom of a holiday home with the beach or forest on your doorstep at Elie Holiday Park, plus much more.

Each park offers dog-friendly holiday homes too and touring caravans, motorhomes, campervans and tents are also welcome.

Come for the day and you'll want to stay longer.

#### Cottages



#### Lodges with hot tubs

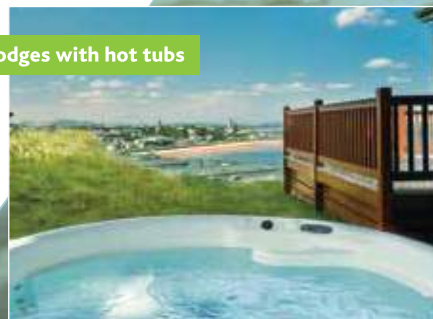

#### Holiday Homes



EARLY  
CHECK-IN  
£30†

#### Tourers



BOOK  
ONLINE  
SAVE  
10%\*

#### Tents



BOOK  
ONLINE  
SAVE  
10%\*



#### BOOK ONLINE TODAY

- ✓ **FREE pitch selection**  
Book online and select your holiday home location or pitch for free\*
- ✓ **EARLY check-in**  
Check-in at 1pm instead of 4pm for £30†
- ✓ **FREE first night**  
Book 5 nights and your first night is free (tourers and tents)\*
- ✓ **SAVE 10%**  
Book online and save 10% (tourers and tents)\*

Book online at [abbeyford.com](http://abbeyford.com)

Book online at [abbeyford.com](http://abbeyford.com)



# Your first choice for holidays in Fife

Award-winning  
coastal holiday parks



Robinson Crusoe adventures at Elie Holiday Park



St Monans Holiday Park



Magical moments



East Sands, St Andrews



Elie Holiday Park



Shell Bay at Elie Holiday Park



The Mirador Café at Elie Holiday Park



Book online at [abbeyford.com](https://www.abbeyford.com)

Book online at [abbeyford.com](https://www.abbeyford.com)





Abbeyford Active is an exciting range of activities where you set the pace and do as much, or as little as you like. From breathtaking coastal walks and leisurely strolls through the forest, to an afternoon birdwatching, or a self-guided family rock pool guddle – there's so much to see and do.

Cut down on your packing and hire bicycles for on-park delivery from our partners at 2 Wheel Care and enjoy a 10% discount. You can also enjoy favourable rates on most tee times at Charlton Golf Club in Colinsburgh. Our friends at Elie Watersports offer an exhilarating range of activities including sailing, windsurfing, paddleboarding and canoeing, plus you can save 10% - remember to quote 'Abbeyford Leisure'. Look out for our free summer football coaching sessions at Elie Holiday Park. Brought to you in partnership with AM Soccer Club the classes are open to 5-12 year old boys and girls who want to develop their skills.

*Most activities are self-guided. Cycle-hire provided by 2 Wheel Care. Watersports activities provided by Elie Watersports. Football coaching provided by AM Soccer Club.*

CANOEING

10 per cent off watersports for Abbeyford Leisure guests

WINDSURFING

SAILING

Share your photos with us



@abbeyfordleisure  
#abbeyfordleisure  
#elieholidaypark  
#standrewholidaypark  
#stmonansholidaypark  
#abbeyfordactive



Close to all the best courses

GOLFING

FOOTBALL COACHING

10 per cent off for Abbeyford Leisure guests

CYCLE HIRE

Pick up one of our free walking guides

WALKING



# MUST TOP 10 SEES

1



*The Fife Coastal Path*

2



*V&A Dundee  
Scotland's Design  
Museum*

3



*Cairnie Fruit Farm  
& Mega Maze*

4



*Claireville  
Alpacas*

5



*Scotland's Secret  
Bunker*

7



*A boat trip  
to the  
Isle of May*

9



*East Neuk Seaweed  
Experience*

6



*Kingsbarns Distillery  
& Visitor Centre*

8



*Craigtown Country  
Park*

10



*Fife Pilgrim  
Way*

Fife and east central Scotland has so much to offer. Spend the day on the beach, take a boat trip to the Isle of May or enjoy a trip to Dundee's spectacular waterfront combined with a visit to the V&A museum of design. For something little different, why not take an alpaca for a walk or discover the delights of foraging and cooking with seaweed! There's so much to see and do on your Abbeyford Leisure holiday – here's ten of the best.



# Coastal Fife at its best



Picturesque Crail

The clear, shallow waters of Elie beach



Fife is one of the sunniest regions in Scotland with an average of 1,500 hours of sunshine per year and is home to no fewer than 15 Seaside Award Beaches. It's where lush green countryside, deserted coves and rugged cliffs intersperse with historic fishing villages and the world's best golf courses. It's a majestic Kingdom like no other and it's waiting to be explored.

The Fife Coastal Path passes by all of our parks and is not to be missed – enjoy views of the Edinburgh skyline, the Isle of May, Bass Rock and beyond.

Our collection of award-winning holiday parks are set in prime coastal locations providing the perfect escape to get away from it all. Stay in a lodge (with hot tub) or holiday home with sea views at St Andrews or St Monans, or enjoy the delights of a holiday home with the beach or forest on your doorstep at Elie. We also welcome touring caravans, motorhomes, campervans and tents. Alternatively, why not stay in one of the Robinson Crusoe Retreat Cottages in the East Neuk seaside village of Lower Largo?



ACCOMMODATION  
AT A GLANCE:



Lodges (with hot tubs)



Castaway (beach) homes



Castaway (forest) homes



Touring pitches



Tent pitches



Watch the Elie Holiday Park video  
at [abbeyford.com](http://abbeyford.com)  
on [facebook.com/AbbeyfordLeisure](https://facebook.com/AbbeyfordLeisure)

# Elie Holiday Park at Shell Bay

The beach  
on your doorstep!

# Elie Holiday Park

*Shell Bay - a hidden gem and a family favourite*

Nestled behind a wide expanse of dunes and a sweeping sandy beach, multi-award-winning Elie Holiday Park at Shell Bay is a true hidden gem. Voted as the **Best Visitor Attraction** in Fife by Kingdom FM listeners and awarded **Scotland's Best Family Holiday Park** runner up, families have been enjoying holidays here for generations and are attracted by the unique location, fantastic entertainment, abundance of wildlife and the exciting Robinson Crusoe Adventure Park. Childhood memories are made here.

There is so much to do and see. You can walk the Fife coastal path, go rock-pooling, spot seals lolloping in the Forth, spy deer bobbing between the trees and, if you're lucky, you may even see a rare red squirrel! Kids can go wild at the Robinson Crusoe Adventure Park and enjoy the exciting arcades and Games Room.

We welcome:



Motorhomes



Campervans



Touring caravans



Trailer tents



Tents



Dogs

Couples will also love Elie Holiday Park. Explore the picturesque fishing villages, enjoy a walk around Ruddons Point (Site of Special Scientific Interest) and catch one of the local summertime festivals. And of course, no holiday to Fife would be complete without a spectacular boat trip to the breathtaking Isle of May National Nature Reserve from neighbouring Anstruther.

Wake-up to some of the very best barista coffee in the East Neuk at The Mirador Café, sample the tasty new menu at the Kincaig View Restaurant and enjoy live entertainment at family friendly Ruddons Bar.

## Accommodation available

- Lodges (with hot tubs & decking)
- Castaway (beach) holiday homes
- Castaway (forest) holiday homes
- Tourer & tent pitches
- Holiday homes for sale

## On Park

- Ruddons Bar
- Live entertainment & events
- Big Screen BT Sport/ Sky Sports
- Darts room & competitions
- Free Wifi (Lodges & holiday homes)
- £ Wifi (Tourers and tents)
- Kincaig View Restaurant
- The Mirador Café & Takeaway
- Mini-supermarket
- Smugglers' Cove Games Room
- Laundry



## Park activities

- Robinson Crusoe Adventure Park
- Direct beach access to Shell Bay
- Fife Coastal Path
- Forest & coastal walks
- Site of Special Scientific Interest - walk to Ruddon's Point
- Countryside ranger visits (high season)
- Football coaching (high season)



See p6

## Nearby

- Largo (birthplace of Robinson Crusoe)
- Lower Largo beach
- Picturesque Elie (beach & harbour)
- Watersports & Golf

"It's the loveliest place to be. I recommend here to everyone, certainly 5 stars."  
Norma from Fife



Fun for all the family

Book online at [abbeyford.com](http://abbeyford.com)

Book online at [abbeyford.com](http://abbeyford.com)



# Fabulous food and family fun at Elie Holiday Park

The Mirador Café  *Kincraig View* RESTAURANT

## Fabulous Food on the Fife Coastal Path

The Mirador Café serves some of the very best barista coffee together with tasty pastries, home baking and top notch takeaway favourites. There are hot breakfast choices too and a light bites menu. There's a dog-friendly room in the café.

Alternatively, The Kincraig View Restaurant offers a delicious menu freshly prepared and expertly created using the very best produce which, wherever possible, is sourced locally. Look forward to a choice of tempting dishes and children's menu. The restaurant is dog-friendly.



*Enjoy pub classics and new favourites*



Chef's homemade soup



Find out more at [abbeyford.com](http://abbeyford.com)



The Mirador Café



*Relive the adventures of Robinson Crusoe*



The Robinson Crusoe Adventure Park



At the heart of Elie Holiday Park is family friendly **Ruddons Bar**. Home to some of Scotland's best bands, singers and acts you can enjoy sounds of the 60s and 70s through to the chart topping hits of the 80s, 90s, 00s and today.

There's live entertainment most weekends and children's entertainment during school holidays, plus the fantastic Smugglers' Cove Games Room and spectacular Robinson Crusoe Adventure Park. Look out for our regular darts and dominoes competitions too!



Smugglers' Cove Games Room



Find out more at [abbeyford.com](http://abbeyford.com)



ACCOMMODATION  
AT A GLANCE:



Lodges (with hot tubs)



Connoisseur holiday homes



Signature Plus holiday homes



Signature holiday homes



Touring pitches



Tent pitches



Watch the St Andrews Holiday Park  
video at [abbeyford.com](http://abbeyford.com)  
on [facebook.com/AbbeyfordLeisure](https://facebook.com/AbbeyfordLeisure)

# St Andrews Holiday Park at Kinkell Braes

The very best  
views of  
St Andrews

Award-winning St Andrews Holiday Park

# St Andrews Holiday Park

## Breathtaking views of St Andrews and beyond

With unrivalled views across azure waters and a magnificent sandy bay towards St Andrews and beyond, award-winning St Andrews Holiday Park is one of the most sought after holiday locations on the east coast of Scotland.

St Andrews is famed for being the home of golf and the park is enviably positioned within easy reach of all the best courses, including the world renowned Old Course. The historic university town is within walking distance of the park and offers an eclectic mix of shops and boutiques and the opportunity to walk in the footsteps of royalty and to take in some sightseeing.

### We welcome:



Motorhomes



Campervans



Touring caravans



Trailer tents



Tents



Dogs

Outdoor types will enjoy the Fife Coastal Path which passes alongside the park taking in rugged cliffs, long sandy beaches and wildlife reserves.

Back on-park is The Braes, an impressive bar and restaurant offering a delicious fresh menu with a focus on speciality burgers. Guests can watch big screen sports, find a quiet spot in the snug or relax with a drink on the sun terrace taking in the sea views. There is also an on-park Papa John's Pizza takeaway with delivery available direct to your holiday home or pitch.

### Accommodation available

- Lodges (with hot tubs, decking & sea views)
- Connoisseur holiday homes (with decking & sea views)
- Signature Plus holiday homes (with decking)
- Signature holiday homes
- Signature Value holiday homes
- Tourer & tent pitches
- Holiday homes for sale

### On Park

- The Braes Bar & Restaurant
- Papa John's Pizza Takeaway
- Sun terrace with sea views
- Live entertainment
- Big Screen BT Sport/ Sky Sports
- Free Wifi (Lodges & holiday homes)
- £ Wifi (Tourers & tents)
- Play Planet Games Room
- Laundry



### Park activities

- Kids' play park
- Direct beach access to East Sands
- Fife Coastal Path

### Nearby

- Watersports
- The home of golf!
- Indoor local swimming pool

“ Fantastic setting, great facilities and very well run. Only 10 mins walk from the town and less than 5 mins from the beach - highly recommended a stay here. Ally from Dundee



The home of golf!

Book online at [abbeyford.com](http://abbeyford.com)

Book online at [abbeyford.com](http://abbeyford.com)





# St Andrews Holiday Park



## The Braes

BAR, RESTAURANT & SUN TERRACE

St Andrews Holiday Park is home to The Braes, an impressive bar and restaurant offering hearty breakfasts, gourmet burgers and pub classics. The vibe is relaxed with a mix of comfy armchairs, booth seating, tables for larger groups and a cosy snug. Relax with a drink al fresco on the sun terrace and enjoy some of the best views of St Andrews. Enjoy regular live weekend evening entertainment, big screen sports, plus free WiFi. There's also a Papa John's Pizza takeaway with delivery available direct to your holiday home or pitch. Well behaved dogs are welcome in The Braes.



*Try a Gourmet Burger*

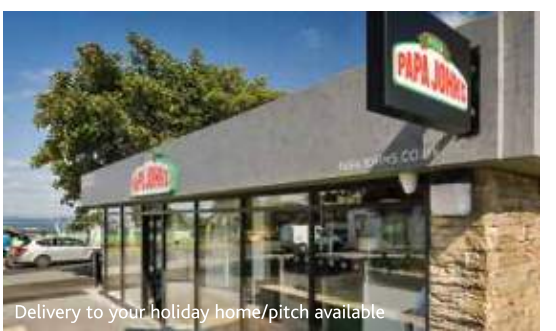

Delivery to your holiday home/pitch available

Book online at [abbeyford.com](http://abbeyford.com)

Book online at [abbeyford.com](http://abbeyford.com)



ACCOMMODATION  
AT A GLANCE:



Castaway Vista holiday home



Signature Plus holiday homes



Touring pitches



Tent pitches

# St Monans Holiday Park



Watch the St Monans Holiday Park  
video at [abbeyford.com](http://abbeyford.com)  
on [facebook.com/AbbeyfordLeisure](https://www.facebook.com/AbbeyfordLeisure)

Award-winning  
St Monans Holiday  
Park

St Monans' iconic windmill on the Fife Coastal Path

# St Monans Holiday Park

*A small park in a prime coastal location*

Award-winning St Monans Holiday Park is set in a prime coastal location, quietly nestled between the East Neuk villages of Elie and Pittenweem.

Overlooking the Fife Coastal Path our Signature Plus and Castaway Vista holiday homes boast stunning sea views and are the perfect escape for a rejuvenating break. There is a dog friendly holiday home too, plus a small touring and tent field located at the entrance to the holiday park.

The beautiful Isle of May National Nature Reserve is a dominant feature on the horizon and is teeming with wildlife.

We welcome:



Motorhomes



Campervans



Touring caravans



Trailer tents



Tents



Dogs

## Accommodation available

- Signature Plus holiday homes (with decking & sea views)
- Castaway Vista holiday home (with decking & sea views)
- Tourer pitches
- Tent pitches
- Holiday homes for sale

## On & Around Park

- Free Wifi (Holiday homes)
- £ Wifi (Tourers and tents)
- Laundry
- Direct access to Fife Coastal Path
- Walking distance from St Monans village

## Nearby

- Local shops & pubs
- Coastal fishing villages of Anstruther, Crail & Pittenweem
- Isle of May National Nature Reserve
- St Monans' Windmill
- Newark Castle ruins
- St Monans' famous zigzag pier
- Kellie Castle
- Bowhouse Market
- Free access to neighbouring Multi Use Games Area
- Free access to nearby Elie Holiday Park

“Lovely park, view from holiday home was fantastic, right across the Forth 5 stars from us.”  
Gordon from West Lothian

This must-see island is a spectacular boat trip away from the bustling seaside town of neighbouring Anstruther.

St Monans has welcomed the rich and famous and is home to an impressive kirk which provided the backdrop to the filming of The Railway Man starring Academy award-winners Colin Firth and Nicole Kidman. It's well worth a visit as is St Monans windmill which was used to pump the salt water into saltpans for drying.



Book online at [abbeyford.com](http://abbeyford.com)

Book online at [abbeyford.com](http://abbeyford.com)





1 bedroom cottage



3 bedroom cottage

# Lower Largo

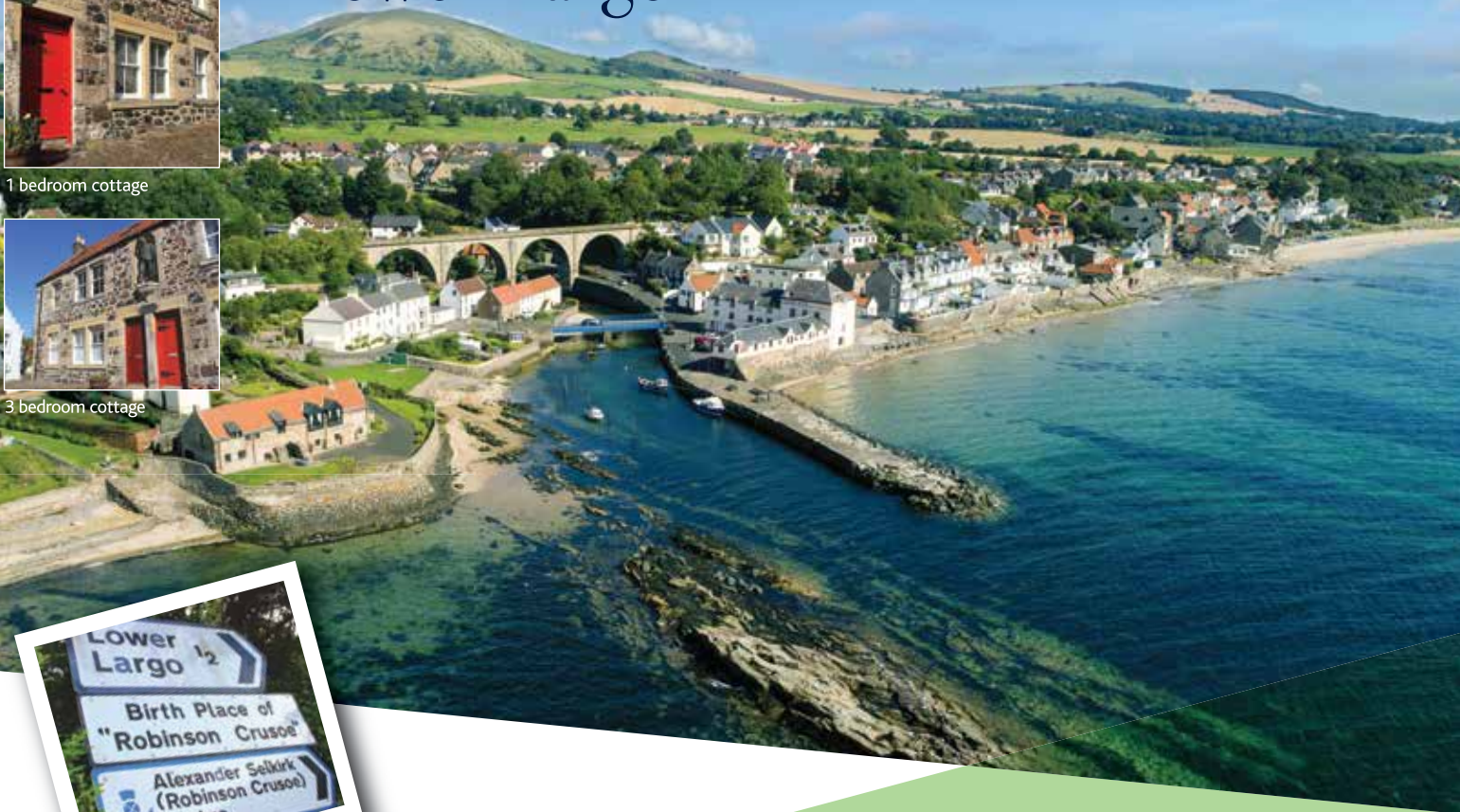

# Robinson Crusoe Retreat Cottages at Lower Largo

*Your perfect hideaway on the Fife coast*

If you love getting away to coastal Fife and the East Neuk, you'll love the Robinson Crusoe Retreat Cottages in picturesque Lower Largo.

Ideal for couples or families, there's a choice of one or three bedroom cottages perfectly located within a few strides of the beach and the Fife Coastal Path, and just a short drive from Elie Holiday Park. Dogs are welcome and there's free Wifi too.

The Retreat is part of the delightful Crusoe Building, a B-listed property which lies on the original site of the

birthplace of Alexander Selkirk - the original castaway that inspired Daniel Defoe to write the tales of Robinson Crusoe.

At bedtime, keep the windows ajar and you can hear the tranquil sound of the waves lapping along the shoreline – magical.

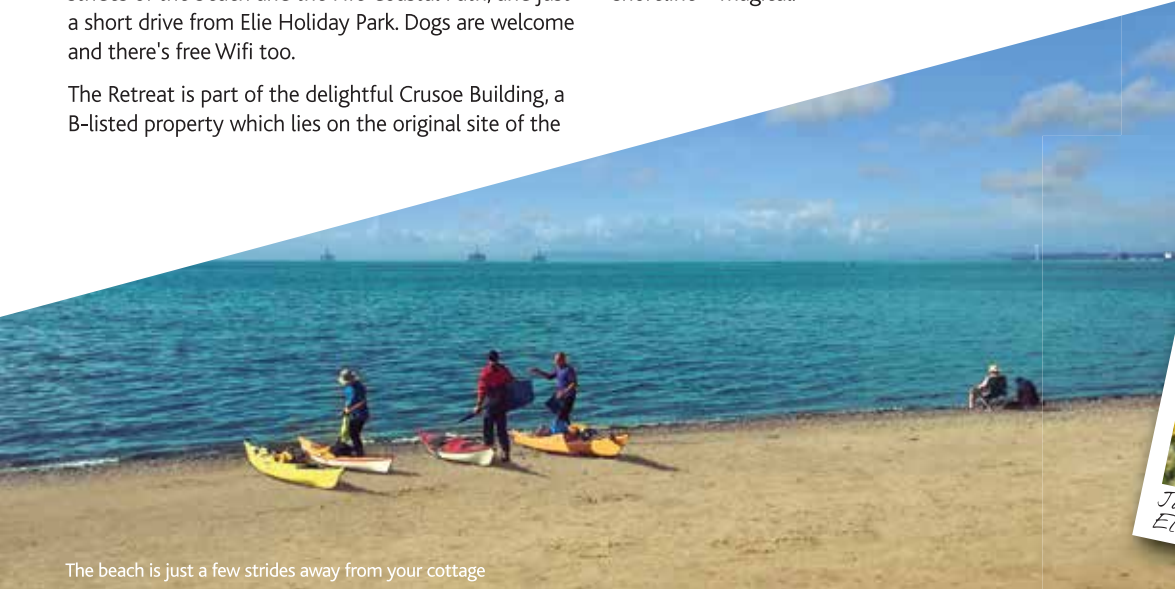

The beach is just a few strides away from your cottage

We welcome:  
  
Dogs

## Accommodation available

- 1 bedroom cottage (101 Robinson Crusoe's Retreat)
- 3 bedroom cottage (103 Robinson Crusoe's Retreat)

## Nearby

- Direct access to Fife Coastal Path
- Direct beach access
- Local shops & pubs
- Lundin Links village
- Lundin Golf Club
- Leven Links Golf Course
- Levenmouth swimming pool
- Free access to nearby Elie Holiday Park

“Loved my stay... the gorgeous beach is right on your doorstep which we had many long walks along. Can't wait to book again for next year.”  
Caza from Scotland

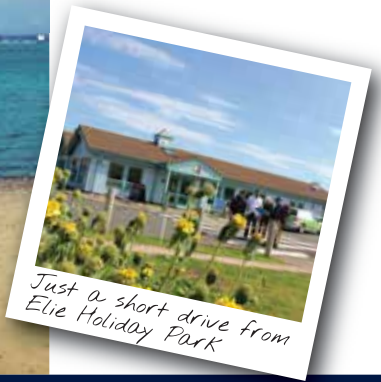

Just a short drive from Elie Holiday Park



## Robinson Crusoe's Retreat Cottages

As standard in both cottages:

- Flatscreen TV with Freeview
- Free Wifi
- Oven, hob & toaster
- Microwave oven
- Fridge-freezer
- Dining area
- Washing machine
- Gas central heating
- Shower room with wc
- Beds made-up for your arrival
- Dog-friendly

**Holiday  
Cottage  
4 nights  
from  
£149**



### 1 bedroom cottage (101 Robinson Crusoe's Retreat)

As standard above, plus:

- Sleeps up to 2
- Ground floor
- Free logs for log-burning fire

### 3 bedroom cottage (103 Robinson Crusoe's Retreat)

As standard above, plus:

- Sleeps up to 6
- Set over two levels and accessed by several steps to the rear
- Master double bedroom
- Twin bedroom x2
- Bathroom
- Dishwasher
- Free cot & highchair available

# Robinson Crusoe Retreat Cottages at Lower Largo

*Cottage holidays for families and couples on the Fife Coastal Path*

## 1 bedroom cottage

Set on one level, this ground floor cottage has been beautifully restored to make the most of traditional features. It is ideal for couples and comprises one double bedroom, a shower room with wc, a spacious yet cosy open-plan living/dining area with log-burning fireplace and a fully fitted breakfasting kitchen including: fridge-freezer, electric fan oven, gas hob, microwave oven and washing machine.

## 3 bedroom cottage

Set over two levels, this unique cottage is great for families or large groups. It has three bedrooms, a bathroom, a separate shower room with wc and a spacious open-plan living/dining area with fully-fitted kitchen including: fridge-freezer, electric oven and hob, microwave, dishwasher and washing machine.

## Linen and towels included

Included within the price of your holiday is freshly laundered linen and towels ready for your arrival (except for cots).

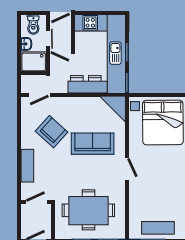

1 bedroom cottage

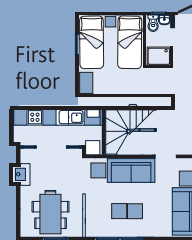

First floor

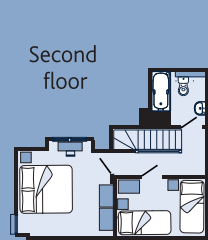

Second floor

3 bedroom cottage



The Robinson Crusoe Retreat Cottages, Lower Largo



103 Robinson Crusoe's Retreat



Lower Largo



101 Robinson Crusoe's Retreat



Close to Elie Holiday Park



## The Lodge at St Andrews

- Sleeps up to 6
- Hot tub, decking and sea views
- Master double bedroom (with TV)
- Ensuite shower room and wc
- Twin bedroom
- Separate shower room with wc
- Large flatscreen TV with Freeview
- Integrated Bluetooth sound system
- Oven, hob, microwave & toaster
- Fridge-freezer
- Free Wifi
- Gas central heating
- Double glazing
- Free cot & high chair available
- Beds made-up for your arrival

**Holiday  
lodge  
4 nights  
from  
£307**

Hot tub with  
sea views

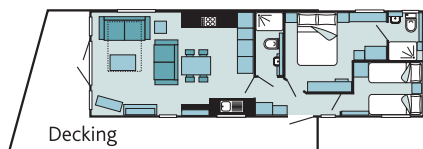
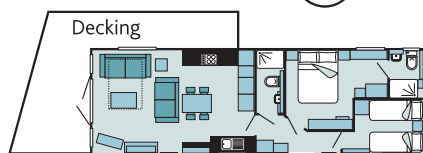

Hot tub with  
sea views

# Lodges at St Andrews

## Lodges with hot tubs and stunning sea views

Set within an exclusive hillside location our Lodges at St Andrews feature breathtaking views of St Andrews, East Sands Beach and beyond - all of which can be enjoyed from the luxury of your own private hot tub or extensive decking.

Everything you need is provided for the best self-catering holiday. The luxury kitchen includes a fridge-freezer, oven, gas hob and microwave, and the spacious living area comprises a separate dining table and chairs, sumptuous sofas and a large flatscreen TV with Freeview.

The spacious master bedroom has a wardrobe, dressing table and comes complete with an ensuite shower room. There is also a twin room and a separate shower room with wc.

### Linen and towels included

Included within the price of your holiday is freshly laundered linen and towels ready for your arrival (except for cots).



Lodges with hot tubs

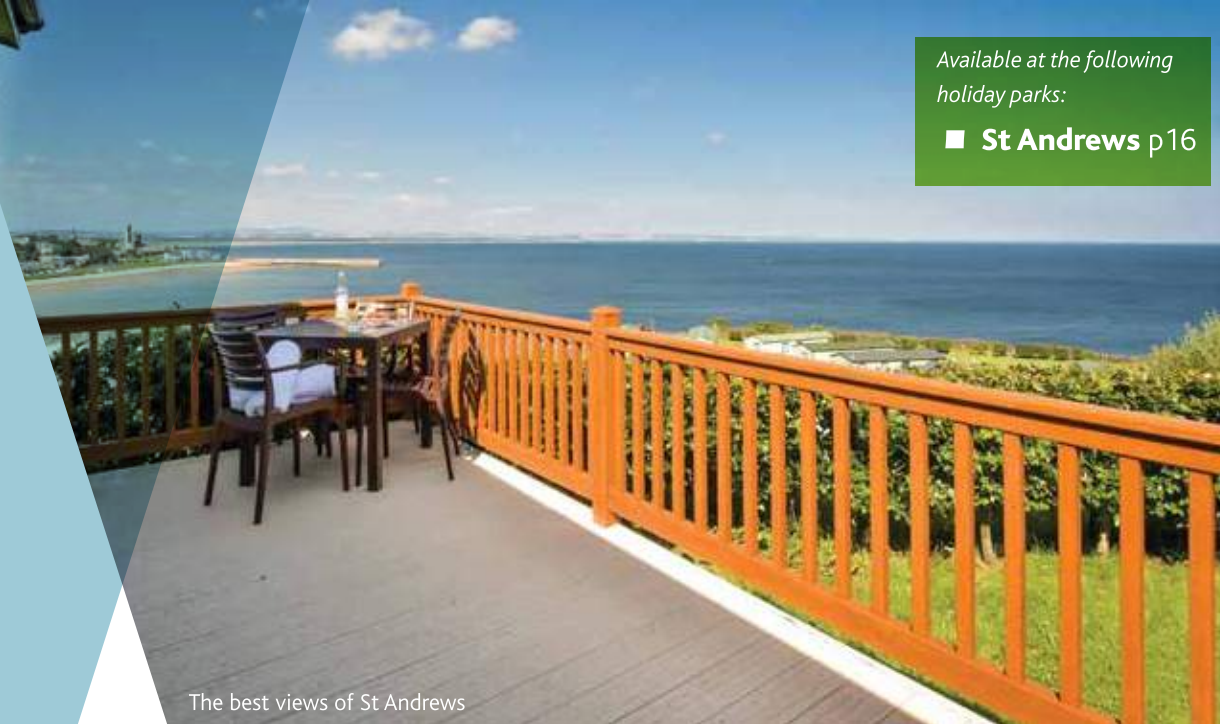

The best views of St Andrews

Available at the following  
holiday parks:

■ **St Andrews** p16



Lounge



Master bedroom





## The Lodge at Elie

- Sleeps up to 6
- Hot tub and private garden
- Spacious decking
- Master double bedroom (with TV)
- Ensuite shower room and wc
- Twin bedroom
- Separate shower room with wc
- Large flatscreen TV with Freeview
- Oven, hob, microwave & toaster
- Fridge-freezer
- Free Wifi
- Gas central heating
- Double glazing
- Free cot & high chair available
- Beds made-up for your arrival
- Dog-friendly accommodation available



**Holiday lodge**  
**4 nights from**  
**£333**

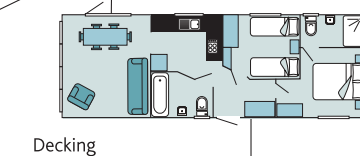

Hot tub

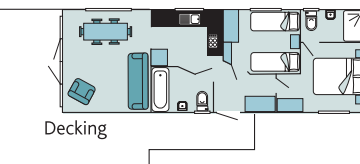

Hot tub

# Lodges at Elie

## Lodges with hot tubs a short walk from the beach

Set just a short walk from the beach at Shell Bay, the Lodges at Elie Holiday Park are conveniently located within easy reach of the shop, bar, restaurant and café. Relax in your own private hot tub within the surroundings of your own garden on the edge of the forest – the perfect tonic for complete relaxation.

Everything you need is provided for the best self-catering holiday. The fully fitted kitchen includes a fridge-freezer, oven, gas hob, microwave and toaster. The spacious living area comprises a separate dining table and chairs, a comfortable sofa and armchair, plus a large flatscreen TV with Freeview. The lounge sofa converts into a double pull-out bed, ideal for inviting extended family or friends. The lounge opens onto spacious decking which affords views towards the beach at Shell Bay.

The spacious master bedroom has a wardrobe, dressing table & TV and comes complete with an ensuite shower room. There is also a twin room and separate bathroom.

### Linen and towels included

Included within the price of your holiday is freshly laundered linen and towels ready for your arrival (except for cots).



Open plan living



Available at the following holiday parks:

■ **Elie\*** p12

Relax in your hot tub

## Lodge with some accessible features

One of the lodges at Elie has a different layout together with a ramp and some other accessible features. Please see the Access Statement at [www.abbeyford.com](http://www.abbeyford.com) for full details.



Lodge hot tub at Elie



Fully-equipped kitchen





## The Connoisseur Holiday Home

- Sleeps up to 6
- 2 bedrooms
- Decking with sea views
- Master double bedroom (with TV)
- Ensuite wc
- Twin bedroom
- Shower room
- Flatscreen TV with Freeview
- Oven, hob & toaster
- Integrated microwave oven
- Fridge-freezer
- Free Wifi
- Gas central heating
- Double glazing
- Free cot & high chair available
- Dog-friendly accommodation available

**Holiday home**  
**4 nights from**  
**£284**

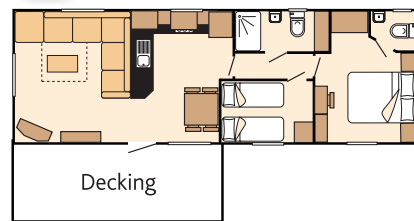

# Connoisseur holiday homes

*Stylish Connoisseur holiday homes complete with decking and spectacular sea views*

Our stylish range of Connoisseur holiday homes at St Andrews Holiday Park offer the best in open-plan living with the added luxury of double glazing, gas central heating and spacious decking, perfect for alfresco dining. A real home-from-home, the Connoisseur is contemporary, yet cosy, with sumptuous lounge seating and a country-style kitchen – fully fitted with everything you need including an integrated microwave oven and toaster.

The focal point of the lounge is the expansive front window affording tremendous views across East Sands Beach, St Andrews and beyond. The lounge seating converts into a double pull-out bed, ideal for inviting extended family or friends, and there's a flatscreen TV with Freeview. The spacious master bedroom includes a TV, dressing table with mirror and an ensuite wc too. The twin bedroom has comfortable beds and a good-sized wardrobe. Set on a terraced hillside, the Connoisseur range of holiday homes offers spectacular views of St Andrews and the bay and all are within a few minutes walk of East Sands beach and the Fife Coastal Path.

Linen, duvets, duvet covers and pillows are all provided (except for cots). For a small charge, you can hire double and single towel packs to save on your packing.

Available at the following holiday parks:

■ **St Andrews** p16

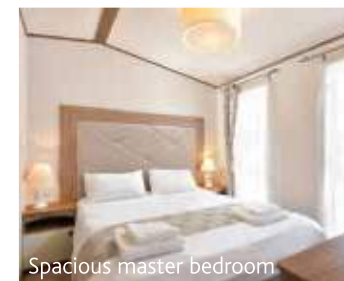



**The Castaway (forest) Holiday Home**

- Sleeps up to 8
- 2 or 3 bedrooms
- Meadow views and a few steps from the forest
- Master double bedroom with ensuite wc (2 bedroom model only)
- Twin bedroom(s)
- Shower room with wc
- Flatscreen TV with Freeview
- Oven, hob & toaster
- Microwave oven
- Fridge-freezer
- Gas central heating
- Double glazing
- Free cot & high chair available
- Dog-friendly accommodation available

**Holiday home**  
**4 nights from**  
**£255**

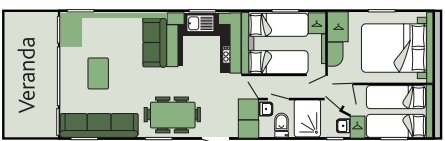

# Castaway (forest) holiday homes

*Castaway homes close to the forest and just a short stroll from the beach*

Our Castaway (forest) holiday homes offer a choice of stylish two or three bedroom models set on the edge of Elie forest with views across grassland towards Kincaig (the highest point on the Fife Coastal Path) and within easy reach of the Robinson Crusoe Adventure Park and Mirador Café. The beach is just a few minutes' walk away.

Each of the holiday homes has double glazing and gas central heating, plus the added luxury of a covered veranda, perfect for alfresco dining, whatever the weather.

The well-equipped kitchen is open plan to the spacious living area, complete with a free-standing dining table, gas fire and flatscreen Freeview TV. There is a master bedroom and a twin bedroom, which is ideal for children or guests. If you have extended family or friends, why not upgrade to the three bedroom model? For your convenience, both offer versatile lounge seating, which converts into a pull-out double bed.

Linen, duvets, duvet covers and pillows are all provided (except for cots).

For a small charge, you can hire double and single towel packs to save on your packing.

Available at the following holiday parks:

■ **Elie** p12



Your own covered veranda for luxury outdoor living



One of the many forest walks



Spacious master bedroom

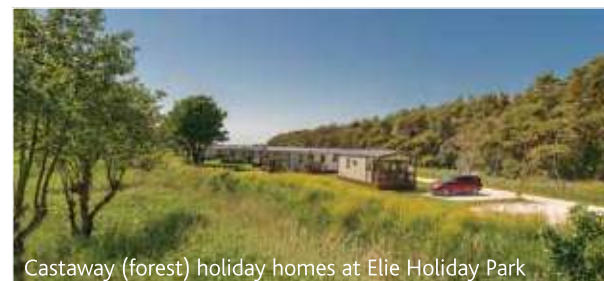

Castaway (forest) holiday homes at Elie Holiday Park



Fully equipped kitchen

Please note, these images may differ slightly from the actual holiday home you book.



**The Castaway (beach) Holiday Home**

- Sleeps up to 8
- 2 or 3 bedrooms
- Covered veranda
- A few steps from the beach
- Master double bedroom with ensuite wc (2 bedroom model only)
- Twin bedroom(s)
- Shower room with wc
- Flatscreen TV with Freeview
- Oven, hob & toaster
- Microwave oven
- Fridge-freezer
- Gas central heating
- Double glazing
- Free cot & high chair available
- Dog-friendly accommodation available

**Holiday home  
4 nights  
from  
£255**

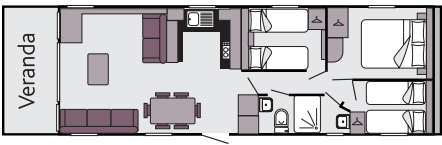
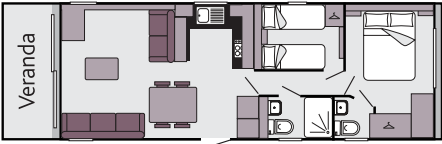

# Castaway (beach) holiday homes

*Castaway homes close to the beach – each with a covered veranda*

Our Castaway (beach) holiday homes offer a choice of stylish two or three bedroom models nestled behind Shell Bay's sand dunes and a stone's throw from the sweeping beach at Elie Holiday Park.

Each of the holiday homes has double glazing and gas central heating, plus the added luxury of a covered veranda, perfect for alfresco dining, whatever the weather. The well-equipped kitchen is open plan to the spacious living area, complete with a free-standing dining table, gas fire and flatscreen Freeview TV. There is a master bedroom and a twin bedroom, which is ideal for children or guests. If you have extended family or friends, why not upgrade to the three bedroom model? For your convenience, both offer versatile lounge seating, which converts into a pull-out double bed.

Linen, duvets, duvet covers and pillows are all provided (except for cots).

For a small charge, you can hire double and single towel packs to save on your packing.



Castaway holiday homes at Elie Holiday Park

Available at the following holiday parks:

■ **Elie** p12



St Monans Windmill

## Castaway Vista holiday home

The Castaway Vista holiday home at St Monans Holiday Park benefits from all the best features of a Castaway home (including a covered veranda) with the added bonus of amazing sea views across the Forth estuary towards the Isle of May and East Lothian coastline.



Open plan living

Please note, these images may differ slightly from the actual holiday home you book.



Your own covered veranda for luxury outdoor living

**Book online at [abbeyford.com](http://abbeyford.com)**

**Book online at [abbeyford.com](http://abbeyford.com)**



## The Signature Holiday Home

- Sleeps up to 8
- 2 or 3 bedrooms
- Decking (*Signature Plus only*)
- Master double bedroom with ensuite wc (*2 bedroom model only*)
- Twin bedroom(s)
- Shower room with wc
- Flatscreen TV with Freeview
- Oven, hob, microwave & toaster
- Free Wifi
- Fridge-freezer
- Gas central heating & double glazing
- Free cot & high chair available
- Dog-friendly accommodation available

**Holiday home**  
**4 nights**  
**from**  
**£199\***

# Signature holiday homes

## Great value family accommodation

The Signature range offers a choice of contemporary two or three bedroom holiday homes which provide the perfect base for a care-free self-catering break. All have the added luxury of double glazing and central heating and our Signature Plus models have decking and patio furniture too. Alternatively, if you're looking for the lowest cost option, the Signature Value model is superb value for money.

The well-equipped kitchen is open plan to the spacious living area, complete with a dining table, gas fire and flatscreen Freeview TV. There is a master bedroom and a twin bedroom, which is ideal for children or guests. If you have extended family or friends, why not upgrade to the three bedroom model? For your convenience, both offer versatile lounge seating, which converts into a pull-out double bed.

Linen, duvets, duvet covers and pillows are all provided (except for cots).

For a small charge, you can hire double and single towel packs to save on your packing.

\*Based on the Signature Value model.

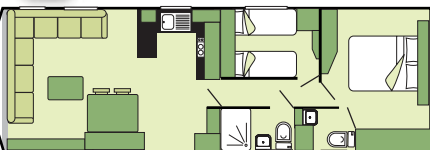

Decking  
(Signature Plus only)

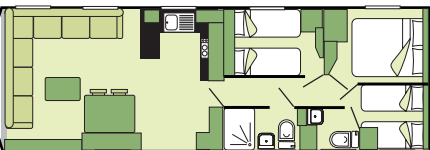

Decking  
(Signature Plus only)



Available at the following  
holiday parks:

- **St Andrews** p16
- **St Monans** p20

Signature holiday homes at St Andrews Holiday Park



Upgrade to the Signature Plus



Master bedroom



Spacious and comfortable accommodation for all the family

Please note, these images may differ slightly from the actual holiday home you book.

## Signature Plus holiday homes

Our Signature Plus holiday homes offer the same high standard of accommodation as the Signature two and three bedroom holiday home range but with the added luxury of decking and patio furniture.

The Signature Plus holiday homes at St Monans also have fantastic sea views (as pictured) and there is a dog-friendly holiday home too.





Book 5 nights & your first night is free\*

Prices include electric hook-up\*

Prices include tourer awning\*

Select your pitch for free\*



BOOK ONLINE SAVE 10%\*



Watch our Holiday Park videos at [abbeyford.com](http://abbeyford.com) on [facebook.com/AbbeyfordLeisure](https://facebook.com/AbbeyfordLeisure)

Elie Holiday Park at Shell Bay

- Available at the following holiday parks:
- Elie p12
  - St Andrews p16
  - St Monans p20



Spires View Touring & Tent Field



\*See pricelist or [abbeyford.com](http://abbeyford.com) for details.

# Tourers, motorhomes, campervans & tents

We welcome touring caravans, campervans, motorhomes, trailer tents and tents – and you can bring along your dog for free. Each of our Fife holiday parks provides the perfect base for exploring the Kingdom's East Neuk and beyond.

Touring pitches from £17.28 per night\* Includes awning and hook-up

Multi-award-winning Elie Holiday Park (voted the Best Visitor Attraction in Fife and awarded Scotland's Best Family Holiday Park runner up) is great for families, has direct beach access and an impressive Robinson Crusoe Adventure Park. St Andrews Holiday Park is set in a prime hillside location with fantastic sea views and St Monans Holiday Park is smaller, more peaceful and a favourite for couples.

Book online and you will automatically save 10% and can select your preferred tourer or tent pitch for free. And that 10% saving is in addition to any applicable 'first night free offer'.\*



St Monans Holiday Park





*Kineraig View*  
RESTAURANT



*The Braes*  
BAR, RESTAURANT & SUN TERRACE



The Mirador Café



Arriving at St Andrews Holiday Park



A warm welcome awaits...

# Tourers, motorhomes, campervans & tents

## Pitch facilities

Our popular touring pitches are a mix of hard gravel and grass surfaces and there is plenty of grass between pitches. All tourer and tent prices are inclusive of electric hook up and there is no extra charge for tourer awnings. Please see individual park pages for full details of park facilities, activities and entertainment. Seasonal pitches sell out very quickly – please contact us as soon as possible.

- Electric hook-ups
- Parking by pitch
- Wash Block
- Laundry
- Baby changing
- £ Wifi
- On-park shop (Elie)
- Nearby shop (St Andrews & St Monans)

## Family friendly bars, restaurants and café

Cooking your own food in the great outdoors is part of the magic of a camping holiday, but don't forget that our bars and restaurants are open for breakfast, lunch and dinner. Look out for speciality burgers at The Braes in St Andrews and some of the best barista coffee and takeaway favourites at The Mirador Café at Elie.



Breakfast at Elie and St Andrews Holiday Parks

\*See pricelist or abbeyford.com for details.

Book online at [abbeyford.com](http://abbeyford.com)

Book online at [abbeyford.com](http://abbeyford.com)



# Creating smiles for over 70 years

There's nothing quite like the freedom of owning a holiday home, it's a tranquil haven for you and your family to spend quality time together, to unwind, relax and have fun.

It's where memories that last a lifetime are created and it's your place to escape to. Look forward to holidays whenever the mood suits you – impromptu weekend getaways, countless bank holiday breaks and long, warm lazy summer days where you set the pace.

Owning a holiday home offers all the best of a second home and much more.

Many of our holiday guests feel so at home at our Parks, that they've gone on to buy a holiday home and are now enjoying holidays whenever they like. Why not call one of our holiday home sales advisors at the Park of your choice to find out more?

Let us  
help you  
find your  
home from  
home







 **Abbeyfordleisure**

Award-winning holiday parks

### Elie Holiday Park

Shell Bay, Elie, Fife KY9 1HB

Call: 01333 330 283

[elie@abbeyford.com](mailto:elie@abbeyford.com)

### St Andrews Holiday Park

Kinkell Braes, St Andrews, Fife KY16 8PX

Call: 01334 474 250

[standrews@abbeyford.com](mailto:standrews@abbeyford.com)

### St Monans Holiday Park

St Monans, Fife KY10 2DN

Call: 01333 730 778

[stmonans@abbeyford.com](mailto:stmonans@abbeyford.com)

### BOOK ONLINE TODAY

#### ✓ **FREE pitch selection**

Book online and select your holiday home location or pitch for free\*

#### ✓ **FREE first night**

Book 5 nights and your first night is free (tourers and tents)\*

#### ✓ **EARLY check-in**

Check-in at 1pm instead of 4pm for £30\*

#### ✓ **SAVE 10%**

Book online and save 10% (tourers and tents)\*

#### ✓ **View holiday homes for sale**

A handpicked selection of new and pre-owned holiday homes available

**Visit [abbeyford.com](http://abbeyford.com)**

\*See pricelist or [abbeyford.com](http://abbeyford.com) for details.

**Book online at [abbeyford.com](http://abbeyford.com)**

