

Holidays across Coastal Fife



Elie • St Andrews • St Monans • Lower Largo

Book Online Today

- ✓ **FREE pitch selection**
Book online and select your holiday home location or pitch for free*
- ✓ **EARLY check-in**
Check-in at 1pm instead of 4pm for £30†
- ✓ **FREE first night**
Book 5 nights and your first night is free (tourers and tents)*
- ✓ **SAVE 10%**
Book online and save 10% (tourers and tents)*



The finest family holidays on the Fife coast

Lodges with hot tubs.



Prime coastal locations.



Holiday homes, many with sea views.



Cosy cottages.



Pitches for caravans, motorhomes, campervans and tents. ^

For more detail scan this QR code or go to:
abbeyford.com



*See abbeyford.com for details. † Available on selected holiday homes (rates may change). ^No tent pitches at St Andrews.



Inspiration

Best Beaches

The Kingdom of Fife is home to no fewer than 15 award-winning beaches, more than any other region in Scotland.

Abbeyford Active

Abbeyford Active is an exciting range of activities where you set the pace and do as much or as little as you like.



Days Out

Spend the day on the beach cooking-up seaweed, take a boat trip to the Isle of May or get up close and personal with alpacas, plus much more.

Watersports

Learn how to sail or try something new like windsurfing or paddle boarding with our friends at nearby Elie Watersports.



Fife Coastal Path

The breathtaking Fife Coastal Path links all three of our award-winning holiday parks and cottages in Lower Largo and is not to be missed.

Football Coaching

Open to 5-12 year olds, our free Easter and Summer Football Coaching Sessions at Elie Holiday Park are brought to you in partnership with AM Soccer Club.



Rock Pooling

Coastal Fife boasts some of the best rock pooling spots including Shell Bay at Elie Holiday Park and East Sands, by St Andrews Holiday Park.

For more detail scan this QR code or go to: abbeyford.com





Elie

Elie Holiday Park at Shell Bay:
Fife's hidden gem.

Elie

Holiday Park



Nestled behind a wide expanse of dunes and a sweeping sandy beach, multi-award-winning Elie Holiday Park at Shell Bay is a true hidden gem.

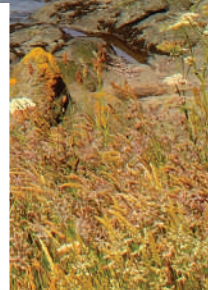

Lodges with hot tubs, stylish holiday homes, pitches for touring caravans, motorhomes, campervans and tents. Set on the edge of the forest, close to the beach.

On park

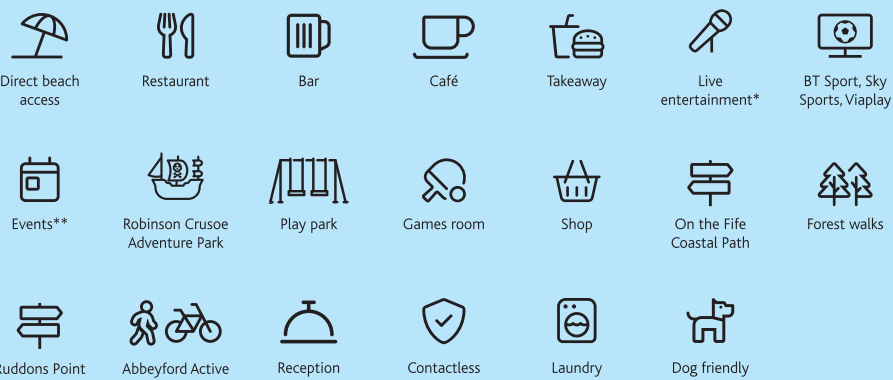

* Most weekends & during school holidays. ** High season

Nearby



There's so much to do and see. Walk the Fife Coastal Path, get wet rock-pooling, go wild at the Robinson Crusoe Adventure Park and spend time together making memories.



Wake-up to some of the very best barista coffee at The Mirador Café. Sample the tasty new menu at The Kinraig View Restaurant and enjoy live entertainment at family friendly Ruddons Bar.

For more detail scan this QR code or go to: abbeyford.com



St Andrews

St Andrews Holiday Park:
Breathtaking views of St Andrews and beyond.





One of the most sought after holiday locations on the east coast of Scotland with a fantastic range of accommodation including lodges with hot tubs, holiday homes with sea views and pitches for touring caravans, motorhomes and campervans.

Unrivalled views across azure waters and a magnificent sandy bay towards St Andrews and beyond.

St Andrews

Holiday Park

St Andrews is famed for being the home of golf and the park is enviably positioned within easy reach of all the best courses, including the world renowned Old Course. The historic university town is within walking distance of the park and offers an eclectic mix of shops and boutiques and the opportunity to walk in the footsteps of royalty and to take in some sightseeing.



On park



Short walk to beach



Restaurant



Bar



Sun terrace



BT Sport, Sky Sports, Viaplay



Live entertainment*



Papa Johns Pizza Takeaway



Contactless check-in



Play park



Games room



On the Fife Coastal Path



Reception



Laundry



Dog friendly

* Most weekends.

Nearby



Free access to Elie Holiday Park



Bars and restaurants



St Andrews town



Picturesque villages



World famous golf courses



Shops



Swimming pool



Wild water swimming



Watersports



Play park

St Andrews Holiday Park is home to The Braes, an impressive bar and restaurant offering a delicious fresh menu with a focus on speciality burgers. Guests can watch big screen sports, find a quiet spot in the snug or relax with a drink on the sun terrace taking in the sea views.



There's an on-park Papa Johns Pizza takeaway with delivery available direct to your holiday home or pitch.



Next door, children can have fun adventures in the play park and Play Planet games room.



For more detail scan this QR code or go to: abbeyford.com



St Monans Holiday Park:
A small park in a prime coastal location.

St Monans

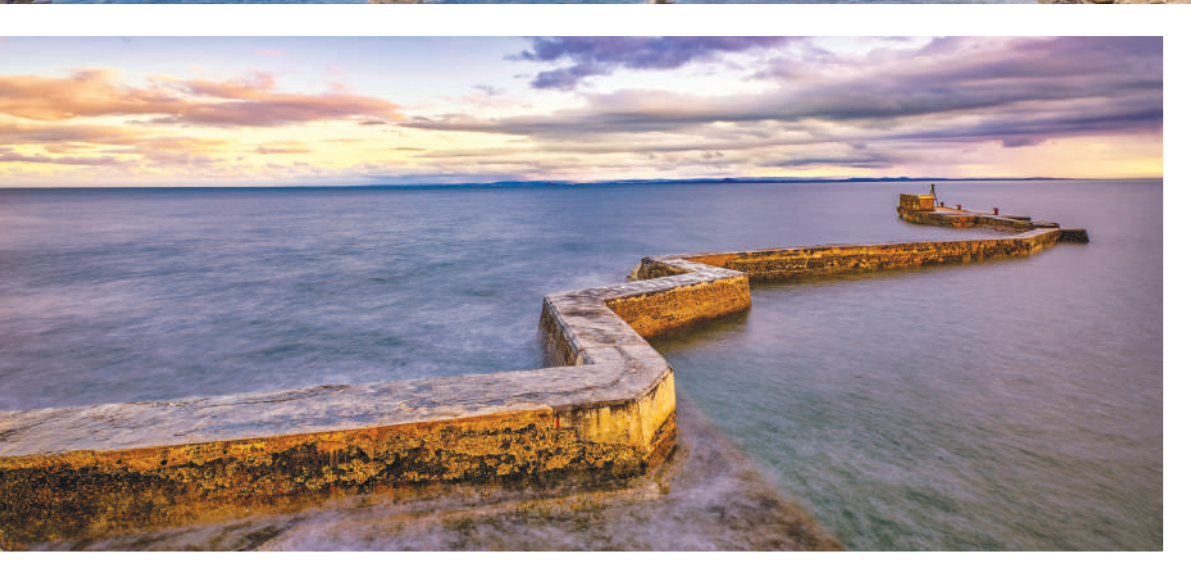

St Monans

Holiday Park



On park



Short walk to beach



On the Fife Coastal Path



Reception



Contactless check-in



Laundry



Dog friendly

Nearby



Free access to Elie Holiday Park



Free access to St Andrews Holiday Park



St Monans Windmill



Bars and restaurants



Wild water swimming



Play park



Picturesque villages



Watersports



World famous golf courses



Isle of May Nature Reserve



Shops

Award-winning St Monans Holiday Park is set in a prime coastal location, quietly nestled between the East Neuk villages of Elie and Pittenweem.

Overlooking the Fife Coastal Path our Castaway Vista and Signature Plus holiday homes boast stunning sea views and are the perfect escape for a rejuvenating break.



Relax on your veranda or decking and take in the breathtaking sea views across the Forth towards the Isle of May and the East Lothian coastline.



The Fife coastline is blessed with many open water or wild swimming opportunities including gently shelving beaches, quiet coves and tantalising tidal pools. The tidal pool in St Monans (pictured) is one of several in Fife that have recently being restored.



The East Neuk of Fife is the ideal location for stargazing and some locals have been fortunate enough to spot the aurora borealis (Northern Lights).

For more detail scan this QR code or go to: abbeyford.com



Robinson Crusoe Retreat Cottages at Lower Largo:
your perfect hideaway on the Fife coast.

Lower Largo



Lower Largo

Robinson Crusoe Retreat Cottages at Lower Largo for families and couples on the Fife Coastal Path.

The Robinson Crusoe Cottages are peacefully located in a quiet corner of Lower Largo, a picturesque East Neuk seaside village set within a few strides of the beach and the Fife Coastal Path, and just a short drive from Elie Holiday Park.



3 bedroom cottage



The cottages are part of the delightful Crusoe Building, a B-listed property which lies on the site of the birthplace of Alexander Selkirk, the original castaway that inspired Daniel Defoe to write the tales of Robinson Crusoe.

Enjoy the best of both worlds: the peace and tranquillity of Lower Largo together with the bar, restaurant, café, games room and beach at nearby Elie Holiday Park (10 minutes drive).

Nearby

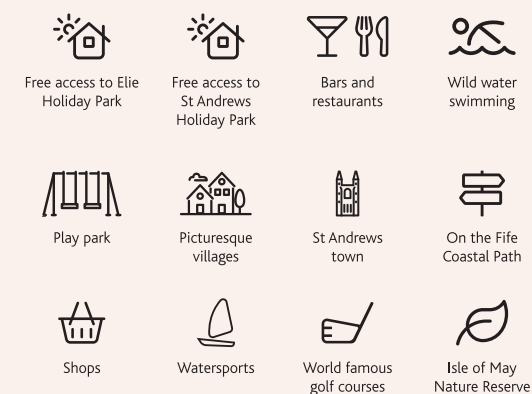

1 bedroom cottage

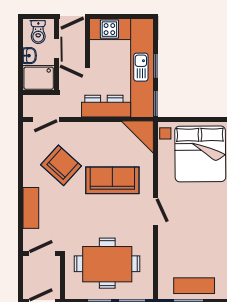

Short-term Lets Licence
FI 00149 F – 101 Main Street
Energy Performance Certificate rating - Band D

3 bedroom cottage

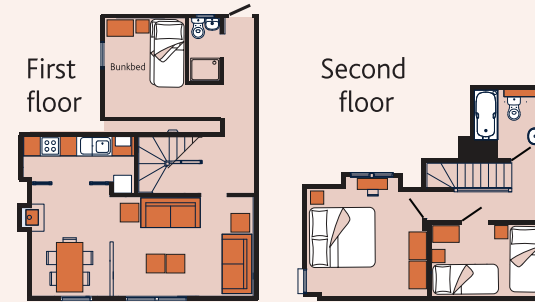

Short-term Lets Licence
FI 00150 F – 103 Main Street
Energy Performance Certificate rating - Band D



For more detail scan this QR code or go to: abbeyford.com



Lodges with hot tubs, a short walk from the beach and Fife Coastal Path.

Available at Elie & St Andrews

Sleeps 6

Bedrooms 2

Hot tub

Sea view (St Andrews)

Outlook doors

Decking

Patio furniture

Free Wi-Fi

Bluetooth sound system

Freeview TV/DVD

Master bedroom

Twin bedroom(s)

Sofa converts to guest bed

Beds made up

Linen and towels provided

Fully fitted kitchen

Kettle & toaster

Microwave

Dishwasher

Dining area

Lounge

WC and shower

Central heating

Cot & high chair available

Iron & ironing board

Dog friendly home available (Elie)

Choose your location for free

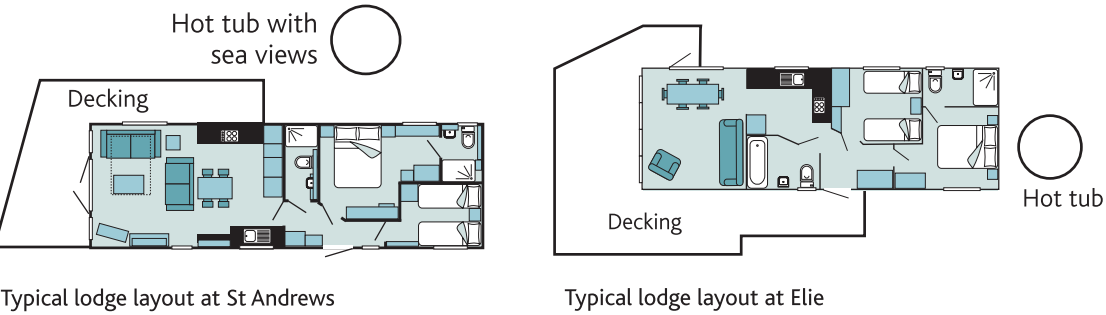

Look forward to slipping into your own outdoor hot tub, the perfect tonic for complete relaxation. Choose St Andrews and enjoy magnificent sea views across East Sands, or go for Elie and relax within the privacy of your own garden on the edge of the forest, just a few steps from the beach.



Our lodge interiors and layouts vary and at Elie Holiday Park one of our lodges has some accessible features including ramped decking and a wet room-style ensuite bathroom with grab rails.



For more detail scan these QR codes or go to: abbeyford.com



Stylish Connoisseur holiday homes complete with decking and spectacular sea views.

Available at St Andrews

- 
Sleeps 6
- 
Bedrooms 2
- 
Sea view
- 
Decking
- 
Patio furniture
- 
Free Wi-Fi
- 
Freeview TV/DVD
- 
Master bedroom
- 
Twin bedroom(s)
- 
Sofa converts to guest bed
- 
Linen provided (except for cots)
- 
Towel hire available
- 
Fully fitted kitchen
- 
Kettle & toaster
- 
Microwave
- 
Dining area
- 
Lounge
- 
WC and shower
- 
Central heating
- 
Cot & high chair available
- 
Iron & ironing board
- 
Choose your location for free
- 
On the Fife Coastal Path
- 
Dog friendly homes available

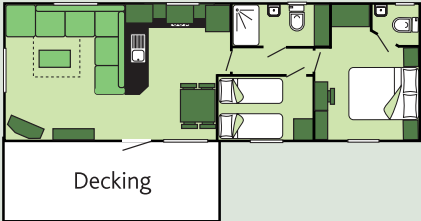

Our stylish range of Connoisseur holiday homes at St Andrews Holiday Park offer the best in open-plan living with the added luxury spacious decking, perfect for alfresco dining. Enjoy tremendous views across East Sands Beach, St Andrews and beyond from the comfort of your lounge. Set on a terraced hillside, each home is conveniently located within easy reach of East Sands beach and the Fife Coastal Path.



The spacious master bedroom includes a dressing table and mirror and there's an ensuite wc too.

For more detail scan this QR code or go to: abbeyford.com



Castaway Sands holiday homes with covered verandas, views towards St Andrews Bay, just a short walk to the beach.

Available at St Andrews

- Sleeps 4-6

Bedrooms 2-3

Partial sea view

Veranda

Patio furniture
- Outlook doors

Free Wi-Fi

EV charging

Freeview TV/DVD

Master bedroom
- Twin bedroom(s)

Linen provided (except for cots)

Towel hire available

Fully fitted kitchen

Kettle & toaster
- Microwave

Dining area

Lounge

WC and shower

Central heating
- Cot & high chair available

Iron & ironing board

Close to the Fife Coastal Path

Dog friendly homes available

Choose your location for free

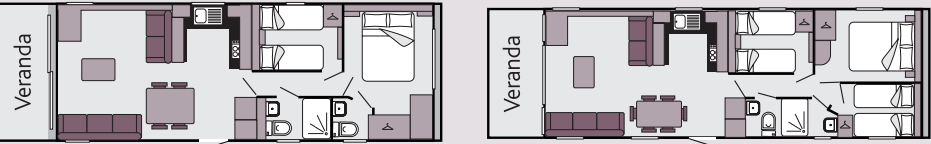

Our chic and on-trend Castaway Sands holiday homes offer a choice of stylish two and three bedroom models with views towards St Andrews Bay, ideally located within a few minutes' walk of East Sands beach and the Fife Coastal Path.



If you have an electric or plug-in car, you'll find an EV charging point outside your accommodation. Select 'EV charging' at time of booking.

For more detail scan this QR code or go to: abbeyford.com



Castaway Beach & Forest holiday homes close to Shell Bay

Available at Elie

- Sleeps **6-8**

Bedrooms **2-3**

Close to beach (Beach homes)

Meadow views (Forest homes)

Veranda

Patio furniture

Outlook doors

Free Wi-Fi

Freeview TV/DVD

Master bedroom

Twin bedroom(s)

Sofa converts to guest bed

Linen provided (except for cots)

Towel hire available

Fully fitted kitchen

Kettle & toaster

Microwave

Dining area

Lounge

WC and shower

Central heating

Cot & high chair available

Iron & ironing board

Choose your location for free

Forest nearby

Close to the Fife Coastal Path

Dog friendly homes available

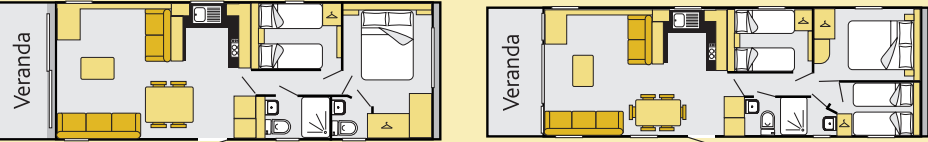

You're never far from the beach when you book a Castaway holiday home at Elie Holiday Park. Our (beach) homes are nestled behind the sand dunes at Shell Bay whilst the (forest) homes are set on the edge of an expansive meadow with a forest backdrop, just a short stroll from the shore.



For more detail scan these QR codes or go to: abbeyford.com



Castaway Beach



Castaway Forest

Castaway Vista holiday homes with covered verandas and spectacular sea views.

Available at St Monans

Sleeps **6**

Bedrooms **2**

Sea view

Veranda

Patio furniture

Outlook doors

Free Wi-Fi

Freeview TV/DVD

Master bedroom

Twin bedroom(s)

Sofa converts to guest bed

Linen provided (except for cots)

Towel hire available

Fully fitted kitchen

Kettle & toaster

Microwave

Dining area

Lounge

WC and shower

Central heating

Cot & high chair available

Iron & ironing board

On the Fife Coastal Path

Dog friendly homes available



Quietly set in a prime location overlooking the Fife Coastal Path and St Monans tidal pool. Our Castaway Vista holiday homes boast big sky outlooks and uninterrupted sea views across the Forth estuary towards the Isle of May.



Go for a revitalising dip in St Monans tidal pool, explore picturesque fishing villages and enjoy the facilities at nearby Elie Holiday Park.

For more detail scan this QR code or go to: abbeyford.com



Our contemporary range of Signature holiday homes offer the perfect base for a care-free self-catering break.

Available at St Andrews & St Monans

- Sleeps
6-8
- Bedrooms
2-3
- Sea view
(St Monans)
- Decking
(Plus homes)
- Patio
furniture
- Free Wi-Fi
- Freeview
TV/DVD
- Master
bedroom
- Twin
bedroom(s)
- Sofa converts
to guest bed
- Linen provided
(except for cots)
- Towel hire
available
- Fully fitted
kitchen
- Kettle &
toaster
- Microwave
- Dining
area
- Lounge
- WC and
shower
- Central
heating
- Cot & high chair
available
- Iron &
ironing board
- Choose your
location for free
- On the Fife
Coastal Path
- Dog friendly
homes available

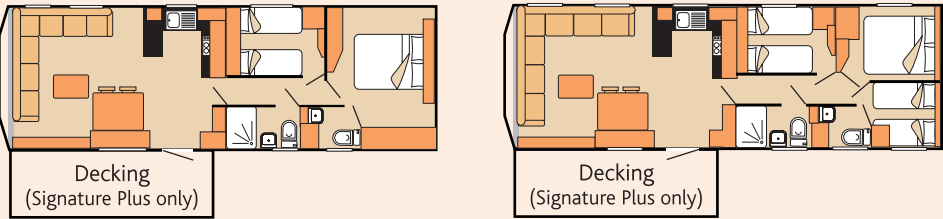

At St Monans, our Signature Plus holiday homes are set in a prime coastal location with stunning sea views providing the perfect escape for a rejuvenating break. Overlooking the Fife Coastal Path they are particularly popular with keen walkers.



Feel the sun on your face, the sand between your toes! Our Signature holiday homes at St Andrews are all within a short walk of East Sands and offer something for everyone. Make the most of the outdoors and upgrade to a Signature Plus complete with the added luxury of your own decking and patio furniture. Alternatively, if you're looking for the lowest cost option, the Signature Value holiday home is superb value for money.

For more detail scan this QR code or go to: abbeyford.com





Pitch-up in your touring caravan, motorhome, campervan or tent[^] and explore coastal Fife at your own pace.



Our holiday parks provide the perfect base for exploring the Kingdom's East Neuk. Elie is great for families, has direct beach access and an impressive Robinson Crusoe Adventure Park. St Andrews is within walking distance of the town and beach and St Monans is smaller, more peaceful and favoured by couples.

St Andrews

St Monans

-  Close to beach (Elie & St Andrews)
-  Partial sea view (Elie & St Andrews)
-  Prices include electric hook-up
-  Prices include awning (tourers)
-  Paid Wi-Fi
-  Choose your pitch for free
-  Charcoal and gas BBQs permitted
-  On the Fife Coastal Path
-  Play park (Elie & St Andrews)
-  Dogs permitted (up to 3)
-  Washrooms
-  Bar (Elie & St Andrews)
-  Restaurant (Elie & St Andrews)
-  Laundry
-  Café (Elie)
-  Papa Johns Pizza Takeaway (St Andrews)



Elie



Our hard gravel touring pitches have plenty of grass in between and prices are inclusive of electric hook-up and awning.

[^]No tent pitches at St Andrews.

Book online and you will automatically save 10% and can select your preferred pitch for free. Book 5 consecutive nights on the same pitch location in one transaction and enjoy your first night free. Book 10 nights and your first 2 nights are free. See abbeyford.com for offer details.

**Book online,
save 10%**

**Book 5 nights & your
first night is free**

**Prices include
electric hook-up**

**Prices include
tourer awning**

**Select your pitch
for free**

For more detail scan this QR code or go to: abbeyford.com



Own a holiday home

Let us help you choose your perfect holiday home on the Fife coast.

There's nothing quite like the freedom of owning a holiday home, it's a tranquil haven for you and your family to spend quality time together, to unwind, relax and have fun. It's where memories that last a lifetime are created and it's your place to escape to.



You can look forward to holidays whenever the mood suits you, impromptu weekend getaways, countless bank holiday breaks and long, warm lazy summer days where you set the pace.



Our pitch fees are inclusive of standing electric charges, local authority rates, water rates and vat and are very competitive. Please see abbeyford.com for more details.

For more detail scan this QR code or go to: abbeyford.com





Late 1940s
We sold trailers and offered tent holidays in North Wales.



Early 1950s
We also traded in horse boxes.



Mid 1955s
Kinkell Braes Caravan Site (now St Andrews Holiday Park).



Late 1950s
Abbeyford Caravan Park in North Wales.



1960s
Serviced caravans arrive at Abbeyford Caravan Park.



1970s
Original head office in Towyn, North Wales.



Late 1970s
Shell Bay Caravan Park (Elie) is acquired.



1980s
St Andrews and St Monans Holiday Parks are acquired.



1990s
Elie Holiday Park at Shell Bay.



2000s
Our first website.



2010
Abbeyford Leisure rebrand.



2011
Robinson Crusoe Adventure Park opens at Elie Holiday Park.



2012
User-friendly website unveiled.



2015
New Castaway Beach holiday homes arrive at Elie Holiday Park.



Late 2015
Online bookings launched.



2016
The Mirador Café opens at Elie Holiday Park.



2018
New Castaway Forest holiday homes unveiled at Elie Holiday Park.

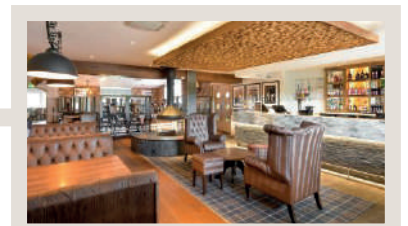

2019
The Braes Bar & Restaurant opens at St Andrews Holiday Park.



Late 2019
Papa Johns opens at St Andrews Holiday Park.



2020-21
Hot tubs are added to lodges.



2022
Latest website launched.



2023
Castaway Sands holiday homes arrive at St Andrews Holiday Park.

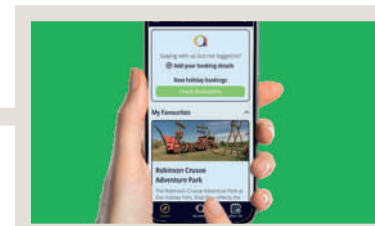

2024
Abbeyford Leisure App is released ready for 2024 holidays.



For more detail scan this QR code or go to:
abbeyford.com



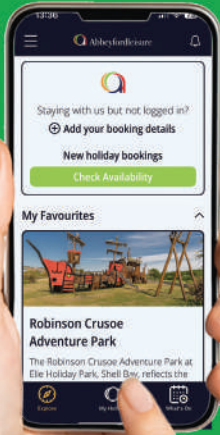

It's your passport to everything you need during your stay and includes your booking summary, places to eat, things to do and is your guide to what's on, plus much more.



Elie Holiday Park

